

MOUNTING HOLES 6 HOLES
 Ø8.15/8.05
 EQUISPACED ON A
 Ø200.025 P.C.
 MINIMUM
 C/BORE Ø17.0

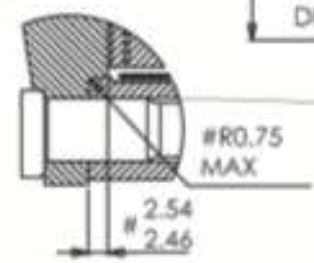

RECOMMENDED CLUTCH
 MOUNTING CP4702-XXX STUD
 AND K-LOCK NUT
 TIGHTENING TORQUE
 22.0Nm (16lb/ft)

A - A
 GEAR DRIVEN
 DRIVEN PLATES

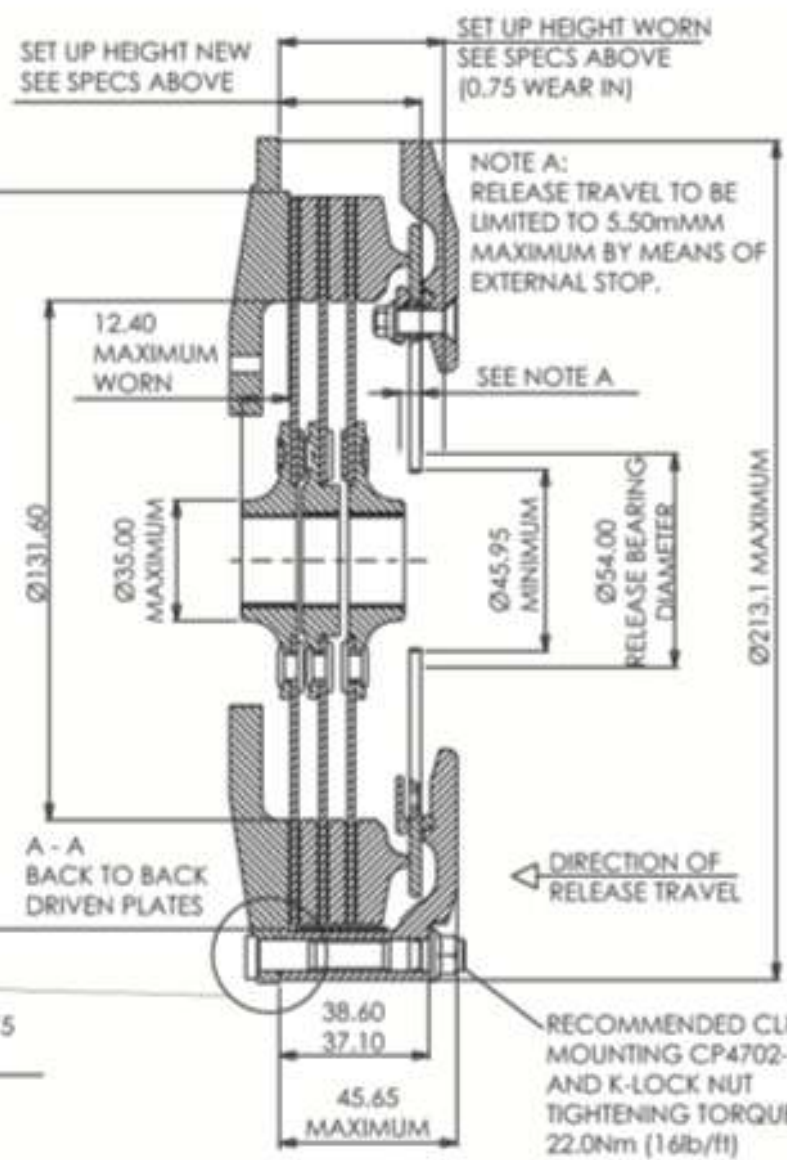